

BOT-R5X/R8X WiFi Wireless Boiler Thermostat Manual

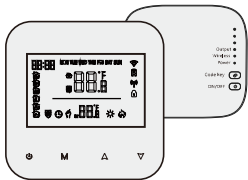

■ application

The wireless intelligent one-to-one digital thermostat is a temperature controller suitable for underfloor heating systems. By comparing the ambient temperature with the set temperature, the working status of the gas wall mounted boiler and electric valve in the underfloor heating system is controlled to achieve the goals of regulating the ambient temperature, comfort, and energy conservation.

■ Electrical specifications

Equipment power supply	3X1.5V alkaline AAA batteries
protection grade	IP20
temperature sensor	NTC
Temperature Accuracy	±0.5°C (adjustable)
Self consumption power	<170uA
LOAD	3A (resistance)

■ Operating instructions

On/Off key: Press the power button once to turn on the device; Press the power button again to turn off the device and close all valves at the same time.

M mode conversion key: In the power on state, press **M** to switch the working mode. The LCD display indicates manual mode, and the display indicates automatic mode.

Δ ∇ adjustment key: When turned on, press the **Δ** or **∇** key to adjust the temperature and other parameters.

Child lock function: Press and hold the **Δ** and **∇** keys for 5 seconds while the device is turned on. When the panel enters the lock key state, a lock icon appears on the right side of the display screen, indicating that the lock key has been successfully pressed.

■ Device network connection settings

When the temperature controller transmitter panel is turned on, press and hold the **Δ** key for 5 seconds until the icon flashes on the temperature controller display screen, and the temperature controller enters the connected state.
Open the Tuya Smart/Smart Life app.

Open the Tuya Smart/Smart Life app.

Find the temperature controller product (Bluetooth-WiFi model) in the (small household appliances) device list. Under the designated distribution mode, click the confirmation button on the page, select the 2.4 GHz WiFi that can connect to the Internet in the device work area and enter the WiFi password. Click Next, click "Connect" according to the page prompts, find the prompt content as instructed, click "Prompt content", and then return to the graffiti APP to enter the distribution process.

■ Panel bracket

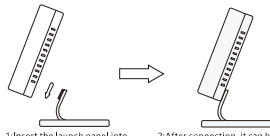

■ Wiring diagram

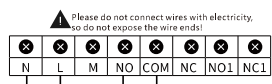

connecting terminal	control equipment	Wiring instructions
NO1	Normally closed electric actuator	Connect NO1 and N
NC1	Normally open electric actuator	Connect NC1 and N
M	External circulation pump (5A)	Connect M and N

Note: Due to the involvement of strong electricity in some circuits of this product, installation must be carried out by professionals.

■ Equipment icon description

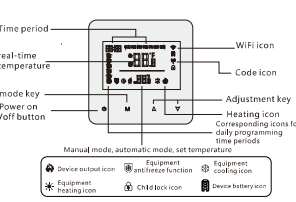

■ Advanced Device Options Settings

- Clicking on **Δ** and **∇** in the power on state can directly adjust the set temperature. If in automatic mode, it will switch to temporary mode.
- Click the **M** button in the power on state to adjust the working mode, switching between manual and automatic modes.
- Long press the **M** key in the power on state to enter the setting state. There are 4 setting stages, click **Δ** and **∇** to select up and down, and then short press **M** to confirm.

display	Parameter	default	Parameter function
	Temperature compensation	0.0	Temperature compensation ranges 0 ~ 0.9
	Temperature differential status	0.5	What is the setting range for temperature differential status? 0 ~ 1.9
	Equipment antifreeze function	ON	Turn on/off the device's anti-freeze function

	Set the upper temperature limit value	25°C	Adjustable range: 12°C ~ 28°C
	Key sound	ON	Turn on/off device button sound
	Restore device factory settings		Go to restore factory settings default. Hold the M key for 5 seconds to restore the factory settings. Press the confirmation key to restore factory settings.
	Daily programming mode data adjustment		Short press M to select and adjust data from Monday to Sunday, then short press Δ and ∇ to adjust 6 programming points per day.
	Click adjustment functions		Press M to enter the adjustment of the current time and the date of the week, short press M to switch adjustment options, short press Δ and ∇ to add/subtract values from ∇ .

■ Details of Daily Programming Mode

Serial number	Time slot	key	set temperature	key
1	06:00		20°C	
2	08:00		16°C	
3	11:30		16°C	
4	12:30		16°C	
5	17:00		22°C	
6	22:00		16°C	

■ Device code connection settings

- In the power on state, long press the code key on the receiving panel until its signal light starts flashing.
- In the power on state, long press the **∇** key on the transmission panel until the signal light on the reception panel stops flashing.
- When the device is in heating mode, adjust the set temperature to be higher than room temperature. At this time, all three indicator lights on the output signal receiving panel will light up and successfully match the code.

■ Installation Steps

